

Overload Protector (Gauge Saver)



Application:

Designed to protect pressure instruments from pressure exceeding the pressure range by sudden & excessive pressure fluctuation from surge or spike. It safe guards the pressure instruments, gauges, switches or transmitters' by blocking extra high pressure.

Features:

- Nominal Pressure up to 400 Kg/cm²
- 8 Different Adjustable ranges
- Over Pressure upto 600 Kg/cm²

Standard Parameters:

Overload protector type : E01: Below Type
 : E02: Piston Type
 Adjustable Range : E01: 0.6 kg/cm² to 0.8 kg/cm²
 : E02: 1 kg/cm² to 400 kg/cm²
 "O" Ring : Viton
 Max Working Pressure : 600 kg/cm² (Depending on range)
 Operating Temperature : -20°C to 120°C
 Material of Construction : AISI 316 SS

Dimensional Drawing

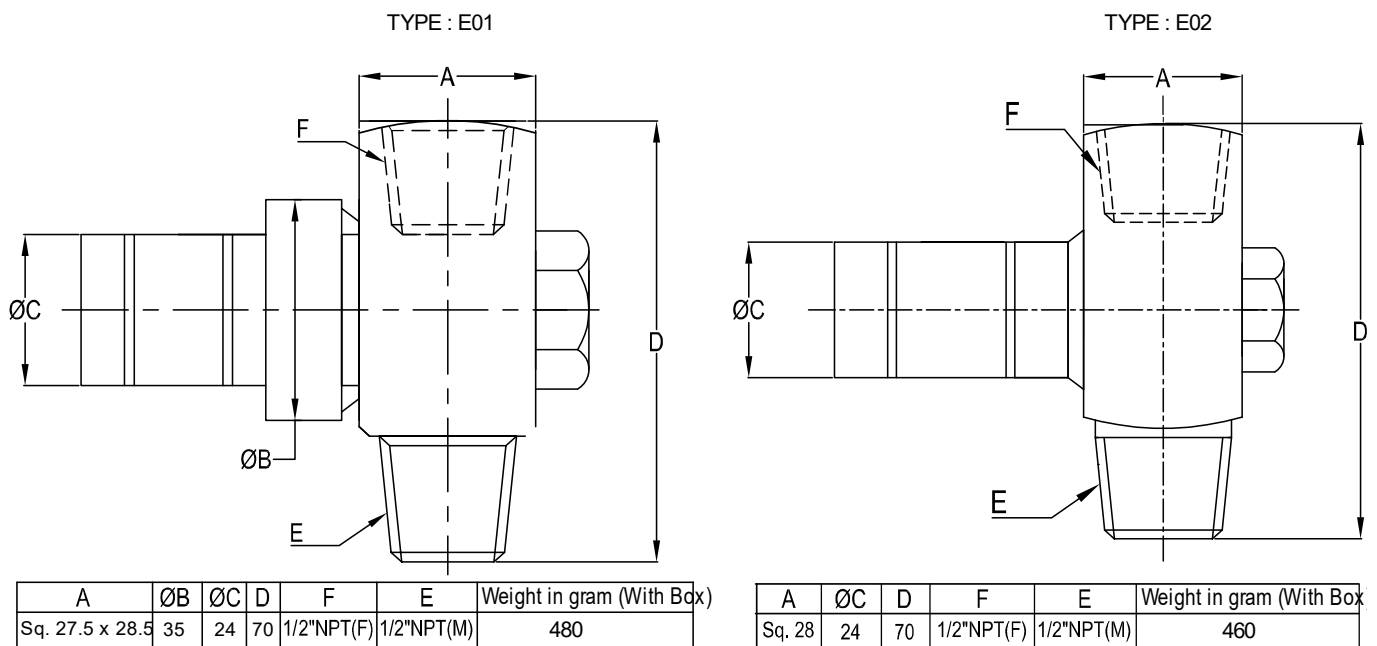

Dimension 'D' will be 73mm in case of 1/2" BSP[M] Connection

Drawings are not to scale. All Dimensions are in mm.

Picture shown above is for demonstration purpose only. Actual Product may differ slightly.

Ordering codes

| | | | | | |
|---|----------------------------|----------------------|-------------------|---------------------------|-----------|
| 1. Type* | | E02: 7-16 | 4. Options | | MT |
| E01 | Below : 0.6 to 0.8 bar | | OS | Oxygen Service | |
| E02 | Piston: 1 to 4 bar | | MT | Material test certificate | |
| E02 | Piston: 4 to 6 bar | | | | |
| E02 | Piston: 7 to 16 bar | | | | |
| E02 | Piston: 10 to 40 bar | | | | |
| E02 | Piston: 60 to 80 bar | | | | |
| E02 | Piston: 100 to 160 bar | | | | |
| E02 | Piston: 200 to 400 bar | | | | |
| 2. Body | | S6 | | | |
| S6 | AISI SS 316 (Standard) | | | | |
| MO | Monel | | | | |
| HC | Hest alloy C | | | | |
| S6L | AISI SS 316L | | | | |
| 3. Connection | | 10B.10BF | | | |
| 06B.06B | 1/4" BSP [M] x 1/4"BSP[M] | | | | |
| 10B.10B | 3/8" BSP[M] x 3/8" BSP[M] | | | | |
| 15B.15B | 1/2" BSP[M] x 1/2" BSP[M] | | | | |
| 20B.20B | 3/4" BSP[M] x 3/4" BSP[M] | | | | |
| 06BF.06BF | 1/4" BSP[F] x 1/4" BSP[F] | | | | |
| 10BF.10BF | 3/8" BSP[F] x 3/8" BSP [F] | | | | |
| 15BF.15BF | 1/2" BSP[F] x 1/2"BSP[F] | | | | |
| 20BF.20BF | 3/4" BSP[F] x 3/4"BSP[F] | | | | |
| As shown in the examples above the connection can be Male-Male, Male-Female, Female-Female. | | | | | |

*Please Specify Required pressure range or adjustable pressure range while ordering. Otherwise, the protector will be set to first value of adjustable range table. Normally the factory setting is done at 130% of instrument range.
Example: If your instrument range is 0-10 kg/cm² then considering over pressure of 130%, the gauge saver set point will be at 13kg/cm². Hence your adjustable range falls in between 7 to 16 Kg/cm². Select the gauge saver adjustable ranges accordingly.

Ordering Example: OP-E02:7-16-S6-10B.10BF-MT

Note: Specifications and dimensions given in this product catalogue represents the state of engineering at the time of printing. Modifications may take place and materials specified may be replaced by others without prior notice.