

# Diaphragm seal

## Direct coupled (Compact type)



### Features:

- Compact design
- Low-cost version
- All SS construction
- The diaphragm is welded to the body to ensure separation of the filling fluid from the process medium.

### Applications:

- Diaphragm seals are designed to isolate the sensing element of pressure gauges and pressure switches from process fluids that they may be corrosive, viscous, sedimentous and / or with a high temperature.

### Standard Parameters

Range	: 1 to 21 kg/cm <sup>2</sup>
Process temperature	: - 40 °C to 200 °C or as per fill fluid
Instrument connection	: 1/4" BSP[F]
Process connection	: 1/4" BSP[M]
Fill fluid	: Silicon Oil - DC 200

### Materials of Construction

Diaphragm	: AISI 316L SS
Body	: AISI 316 SS

### Dimensional drawing

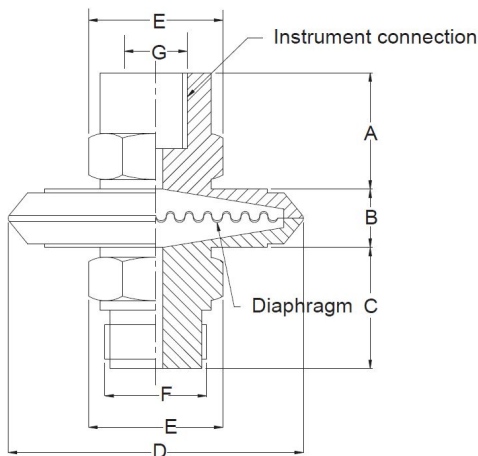

A	B	C	D	E	F	G	Wt.
26	14	23	62	Hex A/F 19	1/4" BSP[M]	1/4" BSP[F]	260

Wt. = Approx. weight in grams

Note: ● Drawings are not to scale ● All dimensions are in mm

Ordering Codes

<b>1. Instrument Connection</b>		<b>06BF</b>
<b>06BF</b>	1/4" BSP[F]	
<b>06NF</b>	1/4" NPT [F]	
<b>2. Body</b>		<b>S6</b>
<b>S6</b>	AISI 316 SS	
<b>3. Diaphragm</b>		<b>S6L</b>
<b>S6L</b>	AISI 316L SS (Standard)	
<b>4. Process Connection</b>		<b>06B</b>
<b>06B</b>	1/4" BSP[M]	
<b>06N</b>	1/4" NPT[M]	
<b>5. Filling Fluid</b>		<b>FG</b>
<b>S1</b>	Silicon DC 200 [-40 to 205°C]	
<b>S2</b>	Silicon DC 704 [10 to 337°C]	
<b>S3</b>	Silicon DC 710 [7 to 371°C]	
<b>FG</b>	Food Grade Oil [-20 to 140°C]	
<b>6. Other Options</b>		<b>MT</b>
<b>HL</b>	Helium leak test	
<b>WI</b>	Dry Seal Only Without Instrument	
<b>MT</b>	Material Test Certificates*	

\*Note: Material test certificates will be provided for wetted parts only with chemical composition testing. For others, please consult factory.

Ordering example: CD-06BF-S6-S6L-06B-FG-MT

1. Specifications and dimensions given in this product catalogue represents the state of engineering at the time of printing. Modifications may take place and materials specified may be replaced by others without prior notice.