

# SYPHON

SY

## Application

SIPHONS ARE USED MAINLY TO PROTECT PRESSURE INSTRUMENTS, GAUGES, SWITCHES AND TRANSMITTERS DIRECTLY COMING IN CONTACT WITH HIGH TEMPERATURE PROCESS FLUIDS OR VAPOURS. THESE ARE MOUNTED BETWEEN PROCESS AND PRESSURE INSTRUMENT. THEY REDUCE PROCESS PULSATION AND GENERATE COOLING EFFECT TO SAVE THE INSTRUMENT.

## Specifications

<b>BODY MATERIAL</b>	AISI 316 Stainless Steel
<b>PIPE SIZE</b>	1/2", Schedule 40
<b>OPERATING PRESSURE</b>	100 kg/cm <sup>2</sup> at 120 °C.

## Special Features

PIGTAIL, COIL AND "U" TYPE SHAPES  
 MAXIMUM TEMPERATURE UP TO 400 °C  
 NOMINAL PRESSURE UP TO 160 kg/cm<sup>2</sup>  
 TIG WELDED & HYDRO TESTED  
 MADE WITH SEAMLESS PIPES

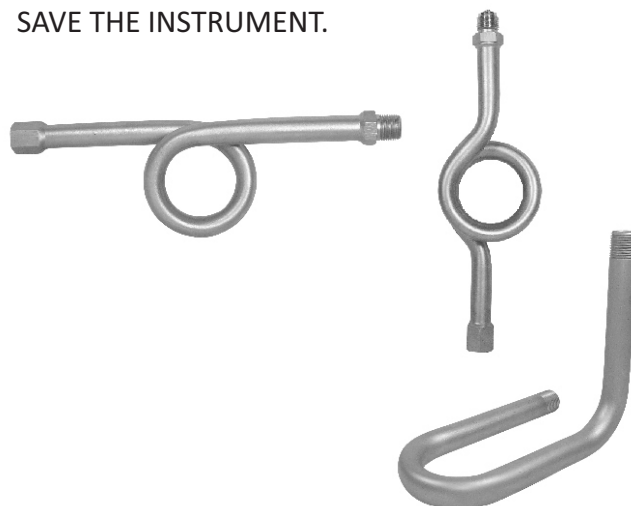

### DIMENSIONS - STANDARD VERSION

#### Coil Type

Pipe size	A	ØB	ØC	ØD	E
1/2" Sch. 40	270	61.5	21.3	15.7	25
1/2" Sch. 80	270	61.5	21.3	13.9	25
1/2" Sch. 160	270	61.5	21.3	11.7	25

A\* = ±5 mm

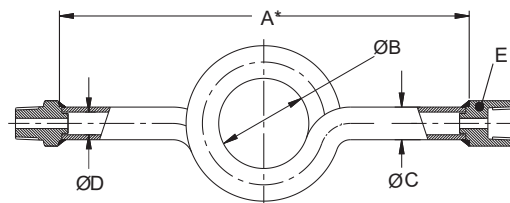

#### Pigtail Type

Pipe size	A	ØB	ØC	ØD	E
1/2" Sch. 40	270	61.5	21.3	15.7	25
1/2" Sch. 80	270	61.5	21.3	13.9	25
1/2" Sch. 160	270	61.5	21.3	11.7	25

A\* = ±5 mm

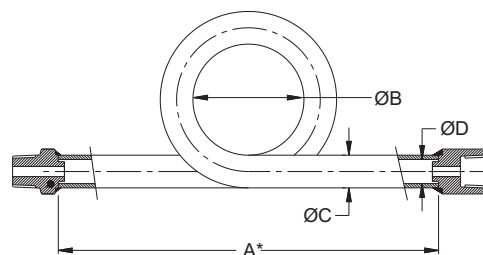

#### "U" Type

Pipe size	A	B	U	ØC	ØD	E
1/2" Sch. 40	169	155	99	21.3	15.7	25
1/2" Sch. 80	169	155	99	21.3	13.9	25
1/2" Sch. 160	169	155	99	21.3	11.7	25

A\* = ±5 mm

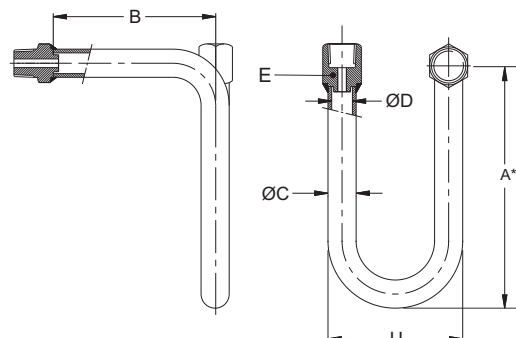

Notes : • Drawings are not to scale. • All Dimensions are in mm.

Notes1 : • Drawings & dimensions of other pipe schedules are available on request.

All Dimensions are in mm, Drawings are not to scale

**HOW TO ORDER**

**BASIC MODEL (WITH PLAIN END)**

**CODE**

**SY**

It is recommended that the Siphon should be filled with water or any other suitable separating fluid, when it is installed first time.

**TYPE**

**CT** COIL TYPE      **PT** PIGTAIL TYPE      **UT** 'U' TYPE

**CT**

**BODY**

**S6** AISI 316 SS (Standard)      **S6L** AISI 316L SS      **S4** AISI 304 SS      **CS** CARBON STEEL (RED OXIDE PAINTED)

**S6**

**PIPE SIZE & SCHEDULE**

**1/4" 40**                      **3/8" 40**                      **1/2" 40**                      **1/2" 160**                      **(1/2 40)**  
**1/4" 80**                      **3/8" 80**                      **1/2" 80**

(Example: Write 1/2 40 to select 1/2" Sch. 40 Pipe)

**CONNECTION TYPE**      (\*Not suitable for NPT threading)

**MU** SWIVEL FEMALE\*                      **MV** MALE OR FEMALE ADAPTOR      **CZ** MALE THREAD ON PIPE

**MU**

**CONNECTION**      (\*Except option MU)

<b>6BM.6BF</b> 1/4" BSP (M x F)	<b>6BM.6BM</b> 1/4" BSP (M x M)	<b>6BF.6BF</b> 1/4" BSP (F x F)	<b>10BM.10BF</b>
<b>6NM.6NF</b> 1/4" NPT (M x F)*	<b>6NM.6NM</b> 1/4" NPT (M x M)	<b>6NF.6NF</b> 1/4" NPT (F x F)*	
<b>10BM.10BF</b> 3/8" BSP (M x F)	<b>10BM.10BM</b> 3/8" BSP (M x M)	<b>10BF.10BF</b> 3/8" BSP (F x F)	
<b>10NM.10NF</b> 3/8" NPT (M x F)*	<b>10NM.10NM</b> 3/8" NPT (M x M)	<b>10NF.10NF</b> 3/8" NPT (F x F)*	
<b>15BM.15BF</b> 1/2" BSP (M x F) (Standard)	<b>15BM.15BM</b> 1/2" BSP (M x M)	<b>15BF.15BF</b> 1/2" BSP (F x F)	
<b>15NM.15NF</b> 1/2" NPT (M x F) (Standard)*	<b>15NM.15NM</b> 1/2" NPT (M x M)	<b>15NF.15NF</b> 1/2" NPT (F x F)*	
<b>15NM.PE</b> 1/2" NPT (M) x PLAIN END			

**OPTIONS**

**CW** MARKING BY LASER#                      **GH** MATERIAL TEST CERTIFICATE                      **SX** SS TAG PLATE                      **CW**  
**CX** MARKING BY ENGRAVING#                      **KT** MARKING BY STAMPING\*\*

\*\* AVAILABLE FOR OPTION CR.

# AVAILABLE FOR OPTIONS CQ, CL & CM.

**Ordering Example: SY- CT- S6- (1/2 40) - MU-10BM.10BF-CW**

FOR OTHER OPTIONAL ITEMS, PLEASE CONTACT FACTORY FOR DELIVERY AND MINIMUM QUANTITY OF ORDER.